

FLANGE TYPE acc. ISO 5211	
type	KEY
F10	6x6 [0.24x0.24] ϕ 20[0.79]
F14	8x7 [0.35x0.28] ϕ 30[1.18]

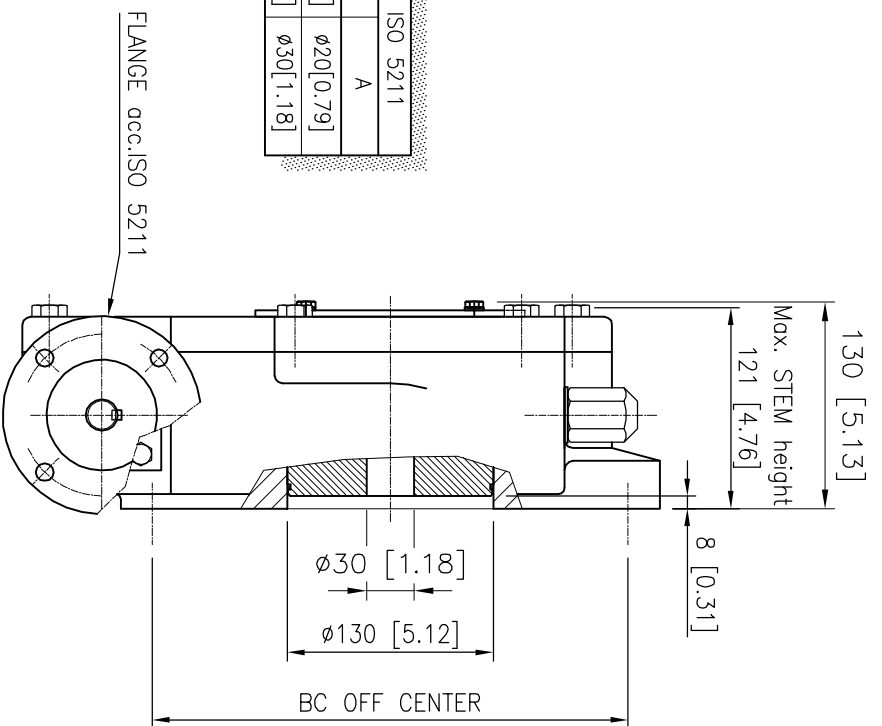

DESCRIPTION

TRAVEL : 90° ±5° AT BOTH ENDS.
 RATIO : 78 : 1
 TURNS TO CLOSE : 19,5
 WEIGHT : 65 kg (143 lb.) exc. handwheel

MOUNTINGHOLES

BOLT CIRCLE : min. ϕ 165 [6.50]
 (OFF CENTER) max. ϕ 298 [11.73]
 acc. ISO 5211 : F16-F25-F30
 BORE : min. ϕ 30[1.18] max. ϕ 100[3.94] #75[2.95]

TORQUE

max.OUTPUT : 8400 Nm (74346 lbf.in.)
 max.INPUT : 305 Nm (2704 lbf.in.)
 M.A. : 27.5 ±15%

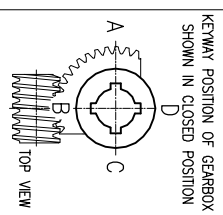

Dimensions in MM [inch]

rotork gears

Nijverheidstraat 25
 The User
 The Netherlands

GEARBOX E 6800G F10-F14 BUL

THIS DOCUMENT IS PROPERTY OF ROTORK GEARS. NEITHER THIS OR ITS CONTENT MAY BE COPIED OR USED IN ANY OTHER WAY DETRIMENTAL TO THE INTEREST OF ROTORK GEARS. ACCEPTANCE OF THIS DOCUMENT SHALL CONSTITUTE ACKNOWLEDGEMENT OF THE FOREGOING CONDITIONS

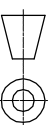

Drawn : P.VH

Date : 28-01-09

Dwg Nr.: E 6800G F10-F14 BUL Rev.: 01

Contents Subject to change without notice.