

MOUNTING HOLES CAN BE POSITIONED ON CTRS BY REMOVING 8 BOLTS INDICATED AND REPOSITIONING

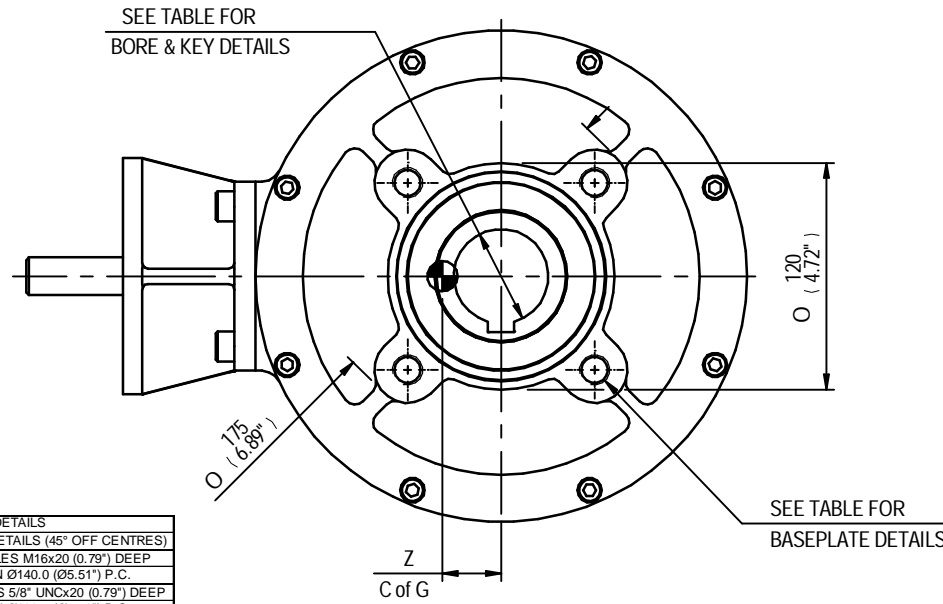

RATIO	M.A.	C.O.G.			MAX OUTPUT TORQUE Nm (lbs.ft)
		X	Y	Z	
3	2.55	0	30	31	1355 (1000)
4	3.40	0	29	30	1355 (1000)
6	5.10	0	30	27	1084 (800)

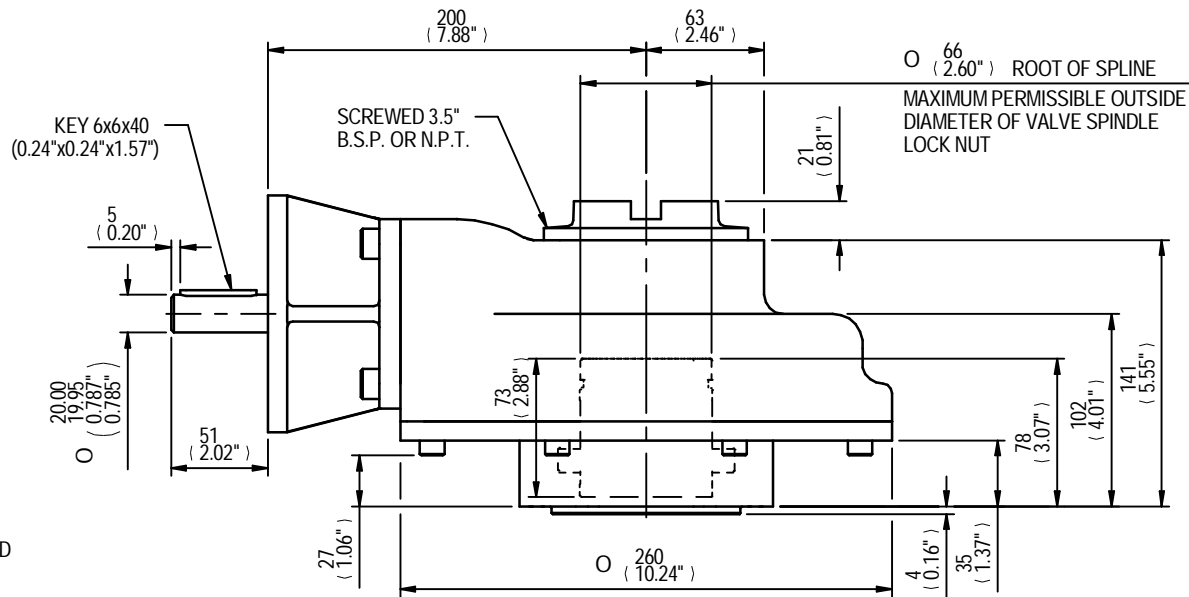
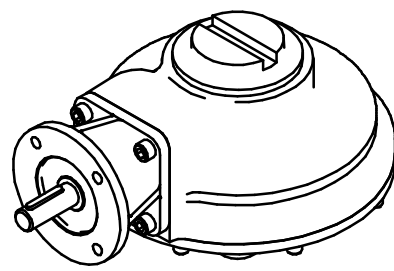

MAX BORE SQ KEY			MAX BORE RECTANGULAR KEY		
STD	BORE	KEY	STD	BORE	KEY
BS4235	-	-	BS4235	52.0	16 x 10
BS46	1.875	1/2" SQ	BS46	2.000	1/2" x 5/16"
ANSI B17.1	1.875	1/2" SQ	ANSI B17.1	2.000	1/2" x 3/8"

MAX STEM SCREW ACCEPTANCE DIA
55 (2.125")

	INPUT FLANGE DETAILS				
	FLANGE	SHAFT	RECESS	RECESS	HOLE DETAILS
	O/DIA. & THICKNESS	DIA.	DIA.	DEPTH	45°(OFF CENTRES) DETAILS
ISO F10	Ø125 x 10	Ø20.00-0.05	Ø70.05+0.05	5	4 HOLES Ø10.5 (Ø0.41")
	(Ø4.92" x 0.39")	(Ø0.787"-0.002")	(Ø2.758"+0.002")	(0.20")	ON Ø102.0 (Ø4.02") P.C. (0.24"x0.24"x1.57")
FA10	Ø125 x 10	Ø20.00-0.05	Ø58.75+0.05	5	4 HOLES Ø10.5 (Ø0.41")
	(Ø4.92" x 0.39")	(Ø0.787"-0.002")	(Ø2.313"+0.002")	(0.20")	ON Ø102.0 (Ø4.02") P.C. (0.24"x0.24"x1.57")

	BASEPLATE DETAILS	
	SPIGOT DIA.	HOLE DETAILS (45° OFF CENTRES)
	O/DIA.	4 HOLES M16x20 (0.79") DEEP
ISO F14	Ø99.95-0.05	ON Ø140.0 (Ø5.51") P.C.
	(Ø3.935"-0.002")	ON Ø139.7 (Ø5.50") P.C.
FA14	Ø95.22-0.10	4 HOLES 5/8" UNCx20 (0.79") DEEP
	(Ø3.749"-0.004")	ON Ø139.7 (Ø5.50") P.C.



IB6 GEAR BOX F10/FA10 INPUT F14/FA14 OUTPUT

DETAILS SUBJECT TO CHANGE WITHOUT PRIOR NOTICE

FOR UP TO DATE DETAILS VISIT www.rotork.com

APPROX WEIGHT 24.0 kg

DRAWING No	PUBIB6-F10-F14	Regina House Ring Road Bramley Leeds LS134ET United Kingdom
ISSUE	A	
DATE	02/05/2011	