

KEY 8x7x55
(0.31"x0.28"x2.17")

SCREWED 4"
B.S.P. OR N.P.T.

Ø 87
(3.43") ROOT OF SPLINE
MAXIMUM PERMISSIBLE OUTSIDE
DIAMETER OF VALVE SPINDLE
LOCK NUT

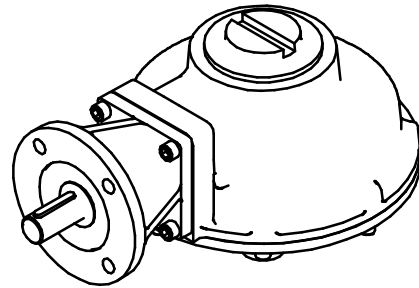
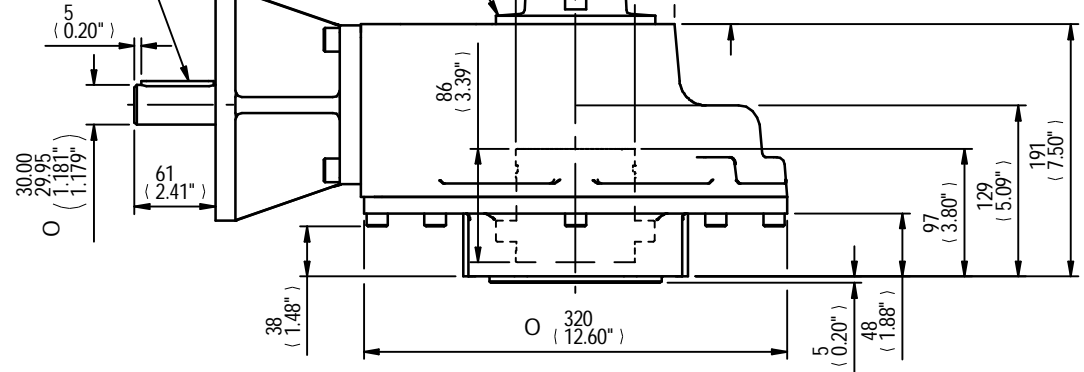

SEE TABLE FOR
BORE & KEY DETAILS

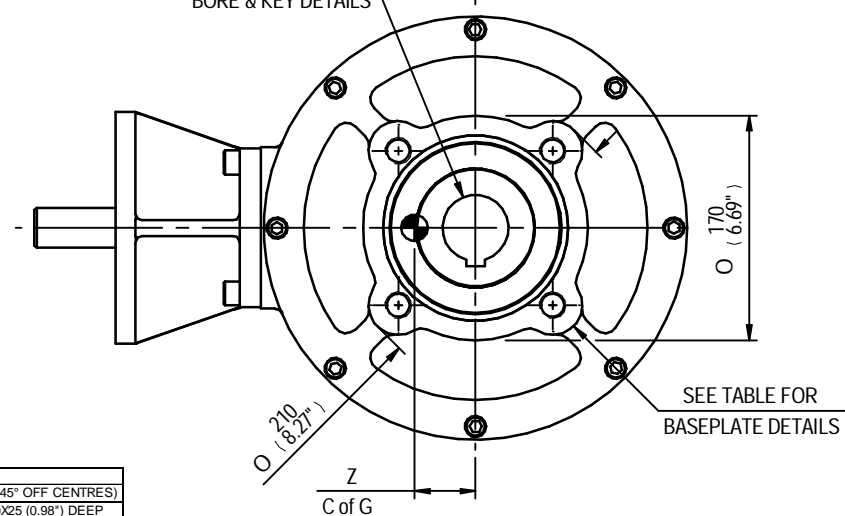

RATIO	C.O.G.			MAX OUTPUT TORQUE Nm (lbs.ft)
	M.A.	X	Z	
3	2.55	0	38 46	2033 (1500)
4	3.40	0	38 45	2033 (1500)
6	5.10	0	38 44	1627 (1200)

MAX BORE SQ KEY			MAX BORE RECTANGULAR KEY		
STD	BORE	KEY	STD	BORE	KEY
BS4235	-	-	BS4235	68.0	20 x 12
BS46	2.500"	5/8" SQ	BS46	2.625"	3/4" x 1/2"
ANSI B17.1	2.500"	5/8" SQ	ANSI B17.1	2.625"	5/8" x 7/16"

MAX STEM SCREW
ACCEPTANCE DIA
73 (2.750")

	INPUT FLANGE DETAILS					
	FLANGE O/DIA. & THICKNESS	SHAFT DIA.	RECESS DIA.	RECESS DEPTH	HOLE DETAILS 45°(OFF CENTRES)	KEY DETAILS
ISO F14	Ø175 x 15	Ø30.00-0.05	Ø100.05+0.05	5	4 HOLES Ø16.5 (Ø0.65")	8x7x55
	(Ø6.89" x 0.59")	(Ø1.181"-0.002")	(Ø3.939"+0.002")	(0.20")	ON Ø140.0 (Ø5.51") P.C.	(0.31"x0.28"x2.17")
FA14	Ø175 x 15	Ø30.00-0.05	Ø95.27+0.05	5	4 HOLES Ø16.5 (Ø0.65")	8x7x55
	(Ø6.89" x 0.59")	(Ø1.181"-0.002")	(Ø3.751"+0.002")	(0.20")	ON Ø140.0 (Ø5.51") P.C.	(0.31"x0.28"x2.17")

	BASEPLATE DETAILS	
	SPIGOT DIA.	HOLE DETAILS (45° OFF CENTRES)
ISO F16	Ø129.95-0.05	4 HOLES M20X25 (0.98") DEEP (Ø5.116"-0.002")
	Ø126.87-0.25	4 HOLES 3/4"UNCX25 (0.98") DEEP ON Ø165.1 (Ø6.50") P.C.
FA16	(Ø4.995"-0.010")	ON Ø165.1 (Ø6.50") P.C.

**rotork
gears**

IB8 GEARBOX
F14/FA14 INPUT F16/FA16 OUTPUT

DETAILS SUBJECT TO CHANGE WITHOUT PRIOR NOTICE

FOR UP TO DATE DETAILS VISIT www.rotork.com

APPROX WEIGHT 51.0 kg

DRAWING No	PUBIB8-F14-F16	Regina House Ring Road Bramley Leeds LS134ET United Kingdom
ISSUE	A	
DATE	04/05/2011	