

1		2		3			4			5			6			7			8		
DESCRIPTION								BORE: STEM ACCEPTANCE WITH KEYWAY IN ACCORDING WITH STANDARD					TORQUE								
RATIO	TURNS TO CLOSE	TRAVEL (1/4 TURN)	WEIGHT	NR OF HOLES	MIN PCD - ØHOLE	MAX PCD + ØHOLE	ACCORDING TO ISO 5211 / MSS SP-101	MIN	MAX	STANDARD	OUTPUT	INPUT	MA								
109:1	27	-5° TO 95°	28 kg 62 lbs	4	Ø 145 mm	Ø 185 mm	F16	Ø35 mm	Ø90 mm	ISO 773 A	4500 Nm	136 Nm	33 ± 15%								
				8	Ø188 mm	Ø270 mm	F25														
				4	Ø 5.709 inch	Ø 7.283 inch	FA16														
				8	Ø7.40 inch	Ø10.62 inch	FA25														

AS PART OF CONTINUOUS PRODUCT DEVELOPMENT, ALL DETAILS SUBJECT TO CHANGE WITHOUT PRIOR NOTICE. FOR UP TO DATE DETAILS PLEASE VISIT [www.rotork.com](http://www.rotork.com)

KEYWAY POSITION OF GEARBOX SHOWN IN CLOSED POSITION

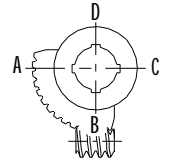

TOP VIEW

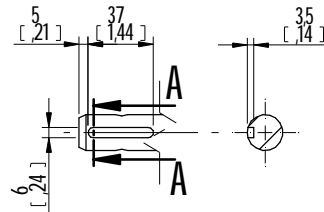
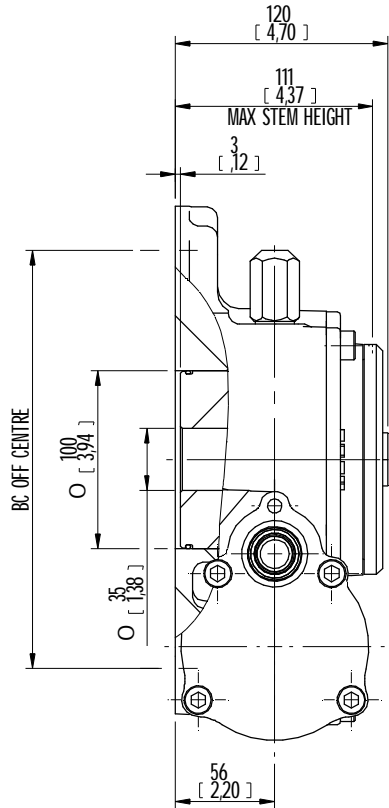

KEY DETAILS

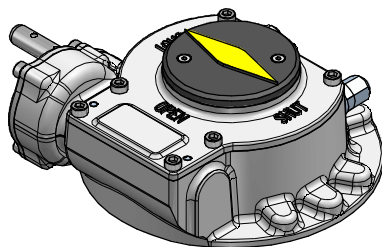
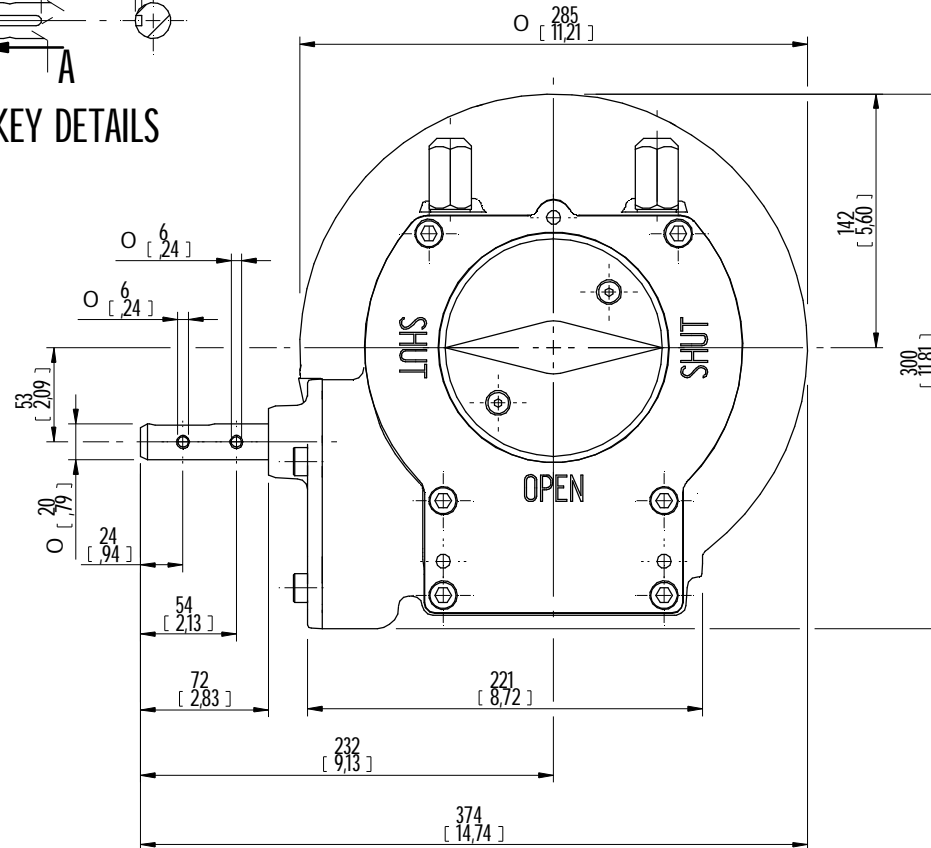

ISOMETRIC VIEW  
1:5

	Document type <b>DETAIL DRAWING</b>		Title <b>AB2000</b>	
	Dimensions in mm Scale 1:3		<b>AB2000 G-TYPE ASSEMBLY F25 BASE, RH PROJECTION</b>	
Created <b>M R</b>	<b>11-12-2012</b>		Drawing Number <b>AB2000G RH LB</b>	
Checked <b>P LINE</b>	<b>28-2-2013</b>		Rev <b>A</b>	
Approved <b>-</b>	<b>DD-1111-YYYY</b>		Sheet <b>1</b> of <b>3</b> Size <b>A3</b>	

00				DD-1111-YYYY	FIRST ISSUE
Rev	CN	Revised	Approved	Date	Change Description