

DESCRIPTION		MOUNTING HOLES - BOLT CIRCLE (OFF CENTRES)				BORE: STEM ACCEPTANCE WITH KEYWAY IN ACCORDING WITH STANDARD			TORQUE				
RATIO	TURNS TO CLOSE	TRAVEL (1/4 TURN)	WEIGHT	NR of HOLES	MIN PCD - ØHOLE	MAX PCD + ØHOLE	ACCORDING TO ISO 5211 / MSS SP-101	MIN	MAX	STANDARD	OUTPUT	INPUT	MA
109:1	27	-5° TO 95°	28 kg	4	Ø104 mm	Ø195 mm	F12 - F14 - F16	Ø35 mm	Ø90 mm	ISO 773 A	4500 Nm	136 Nm	33 ± 15%
				8	N/A	N/A	N/A						
			61 lbs	4	Ø4.09 inch	Ø7.67 inch	FA12 - FA14 - FA16	Ø1.38 inch	Ø2.76 inch	ANSI B17.1	39,828 lbf.in	1204 lbf.in	
				8	N/A	N/A	N/A						

AS PART OF CONTINUOUS PRODUCT DEVELOPMENT, ALL DETAILS SUBJECT TO CHANGE WITHOUT PRIOR NOTICE. FOR UP TO DATE DETAILS PLEASE VISIT [www.rotork.com](http://www.rotork.com)

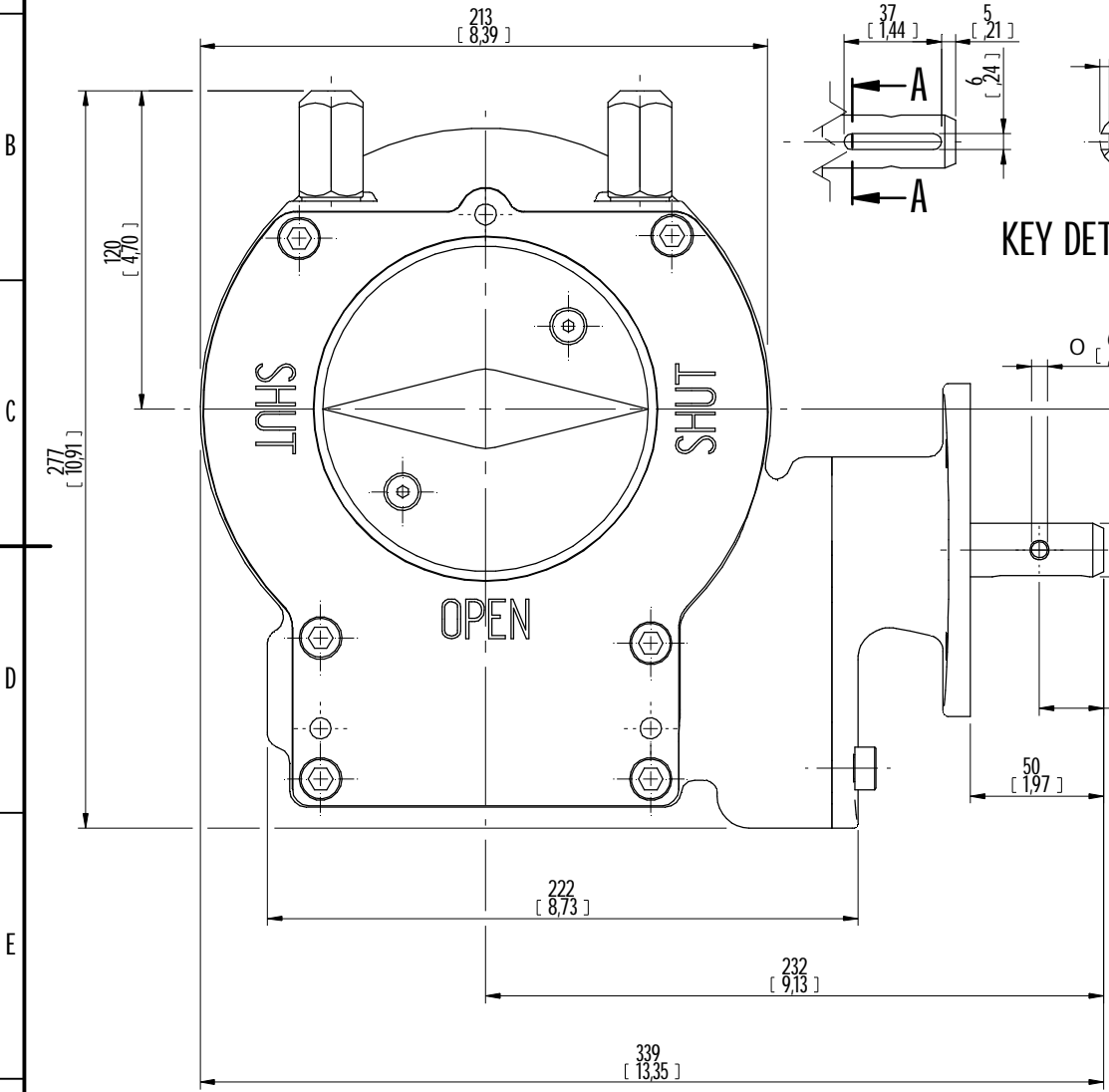
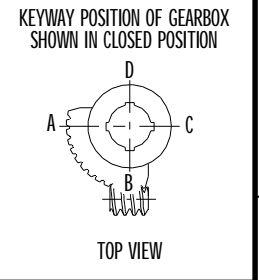

KEY DETAILS

4 HOLES Ø10.5 THROUGH EQUI SPACED ON Ø102 PCD. AS SHOWN

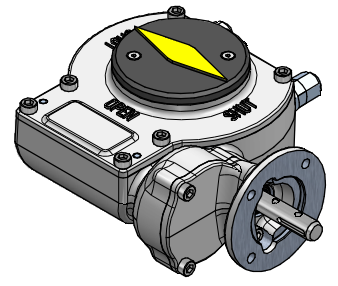
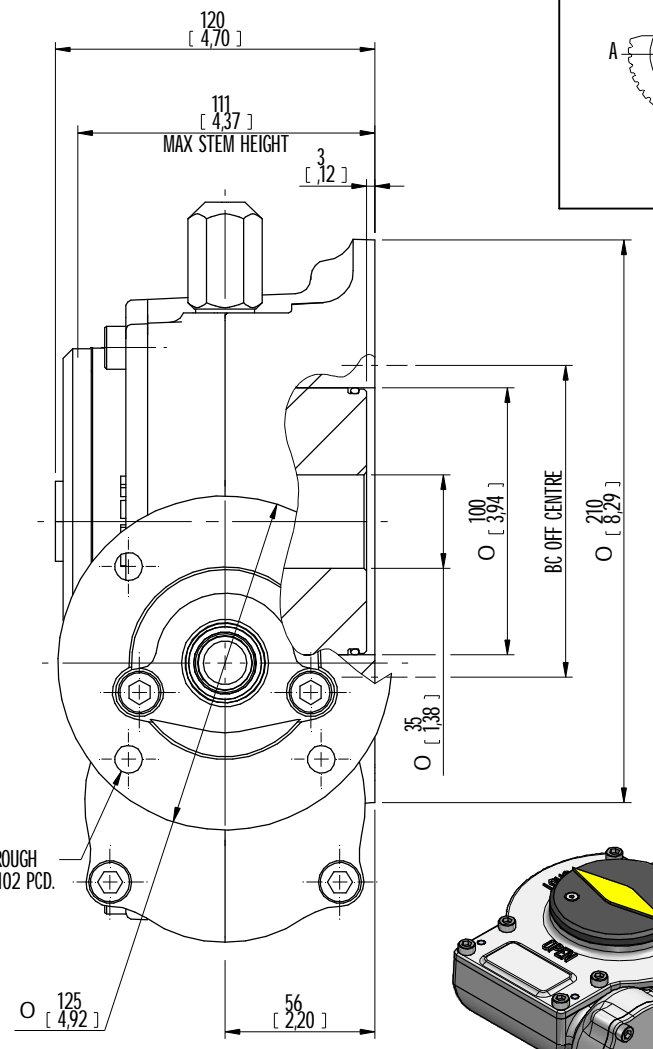

ISOMETRIC VIEW  
1:5

00				DD-MMM-YYYY	FIRST ISSUE
Rev	CN	Revised	Approved	Date	Change Description

 LOSSER - NETHERLANDS <a href="http://www.rotork.com">www.rotork.com</a>	Document type <b>DETAIL DRAWING</b>		Title <b>E2000</b> <b>E2000 G-TYPE ASSEMBLY F16 BASE, LH PROJECTION WITH E-FLANGE</b>	
	Dimensions in mm Scale 1:2		Drawing Number <b>E2000 LH</b>	
Created	M R	18-12-2012	Rev A	
Checked	P LINE	28-2-2013	Rev A	
Approved	-	DD-MMM-YYYY	Sheet 1 of 3	Size A3

Rev 01