

DESCRIPTION				MOUNTING HOLES - BOLT CIRCLE (OFF CENTRES)			BORE; STEM ACCEPTANCE WITH KEYWAY IN ACCORDING WITH STANDARD			TORQUE			
RATIO	URNS TO CLOSE	TRAVEL (1/4 TURN)	WEIGHT	NR of HOLES	MIN ENVELOP PCD - ØHOLE	MAX ENVELOP PCD + ØHOLE	ACCORDING TO ISO 5211 / MSS SP-101	MIN	MAX	STANDARD	OUTPUT	INPUT	MA
326:1	81.5	-5° TO 95°	92.5 kg	4	Ø134 mm	Ø405 mm	F16	Ø30 mm	Ø100 mm	DIN 6885-1	12500 Nm	130 Nm	96.0 ± 15%
			204 lbs	8	Ø134 mm	Ø405 mm	F25 - F30 - F35						
				4	Ø5.28 inch	Ø15.94 inch	FA16	Ø1.18 inch	Ø3.94 inch	ANSI B17.1	110634 lbf.in	1152 lbf.in	
				8	Ø5.28 inch	Ø15.94 inch	FA25 - FA30 - FA35						

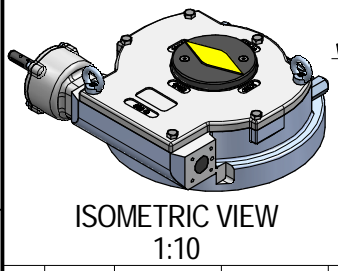
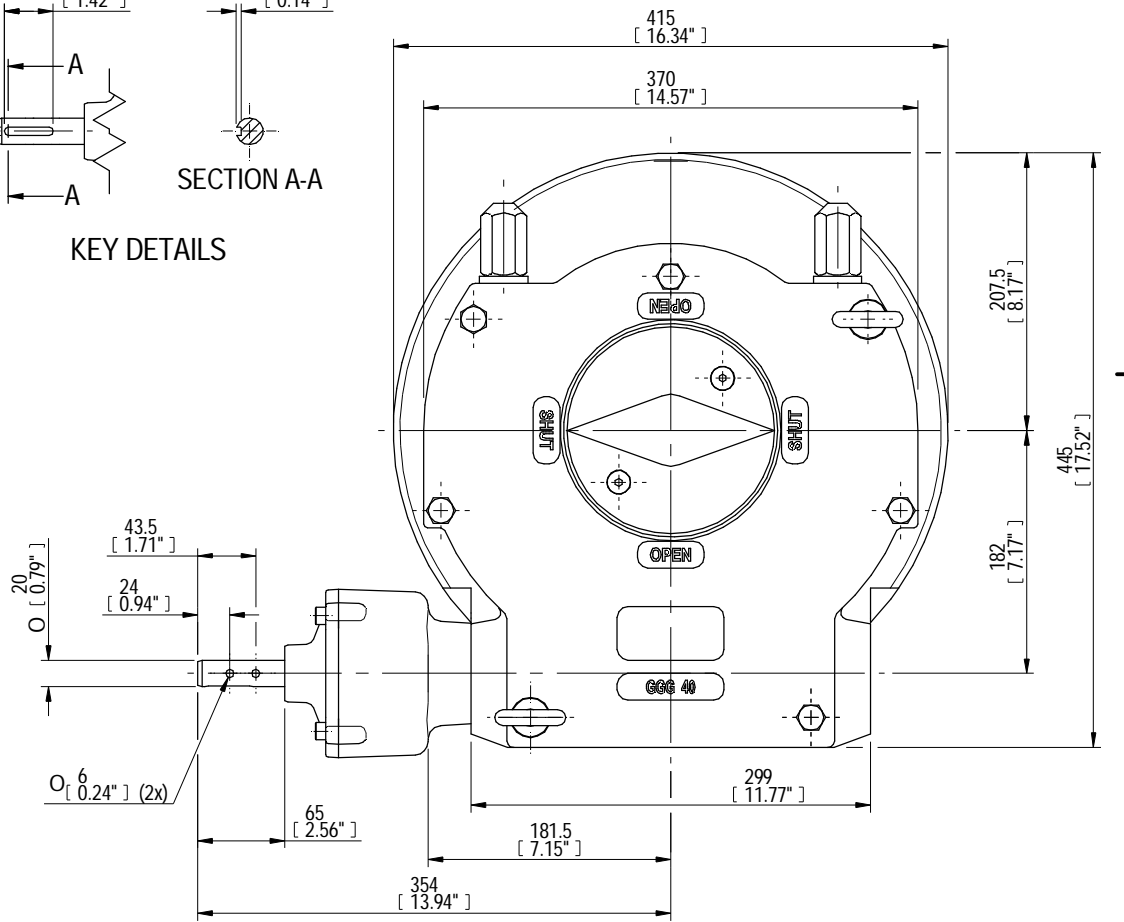
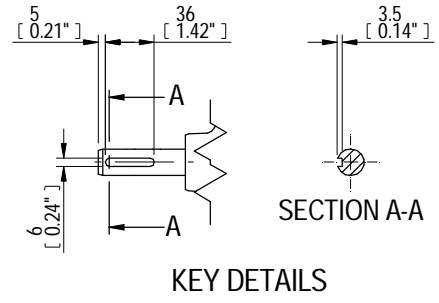
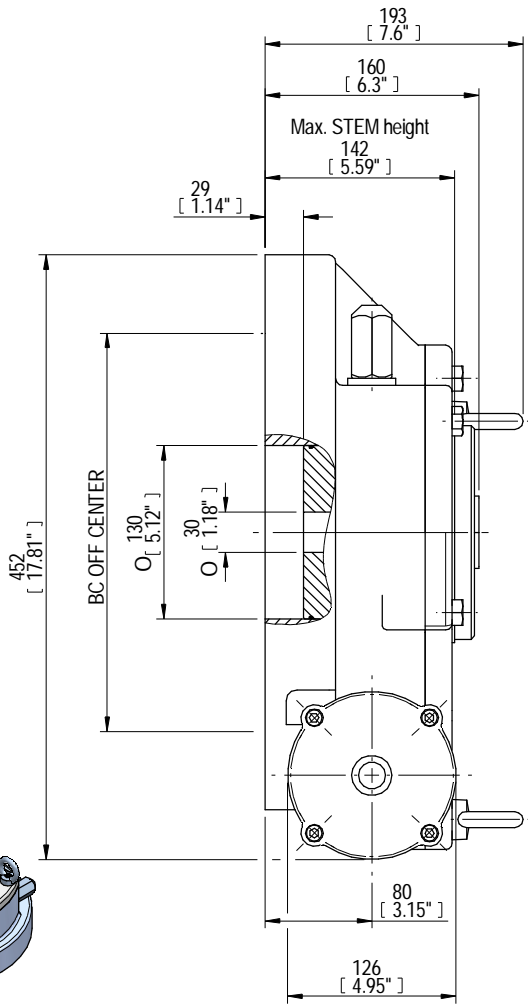
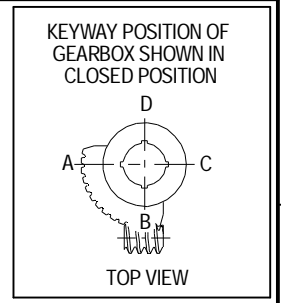

AS PART OF CONTINUOUS PRODUCT DEVELOPMENT, ALL DETAILS SUBJECT TO CHANGE WITHOUT PRIOR NOTICE. FOR UP TO DATE DETAILS PLEASE VISIT [www.rotork.com](http://www.rotork.com)

 LOSSER - THE NETHERLANDS <a href="http://www.rotork.com">www.rotork.com</a>	This drawing is confidential and is the property of Rotork Gears and must not be reproduced either wholly or partly. All rights in respect of patents, designs and copyrights are reserved. © 2013		Document type <b>DETAIL DRAWING</b>	Title <b>AB6800W WITH PR4 RH PLANETARY GEARBOX-PR4</b>
	Dimensions in mm Scale 1:4		Created <b>K. DANIEL</b> <b>11/11/2013</b>	Drawing Number <b>AB6800W-PR4 LB RH</b>
	Checked <b>PRABU.D</b> <b>15/11/2013</b>	Approved	Sheet <b>1</b> of <b>1</b> Size <b>A3</b>	Rev <b>A</b>

Rev	CN	Revised	Approved	Date	Change Description
A				15/11/2013	FIRST ISSUE

Rev.01