

SEE TABLE FOR BASEPLATE DETAILS

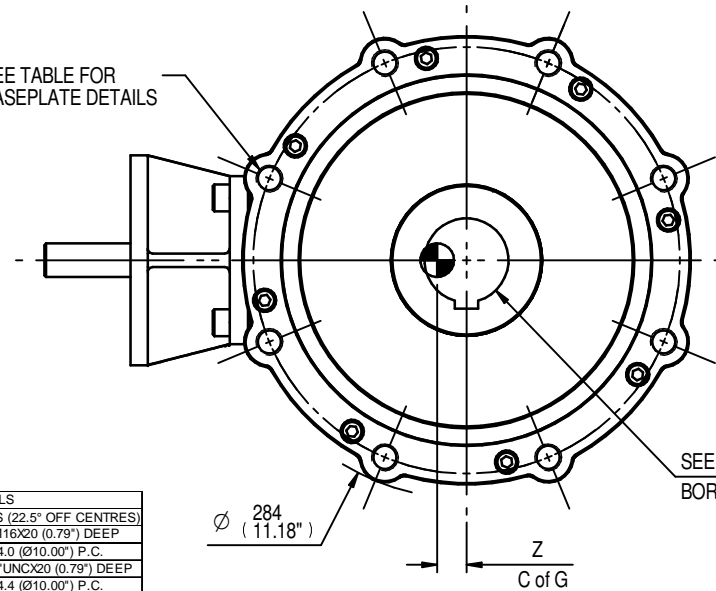

RATIO	M.A.	C.O.G.			MAX OUTPUT TORQUE Nm (lbs.ft)
		X	Y	Z	
3	2.55	0	56	18	1355 (1000)
4	3.40	0	56	17	1355 (1000)
6	5.10	0	56	16	1084 (800)

MAX BORE SQ KEY			MAX BORE RECTANGULAR KEY		
STD	BORE	KEY	STD	BORE	KEY
BS4235	-	-	BS4235	68.0	20x12
BS46	2.500" 5/8" SQ		BS46	2.625" 3/4" x 1/2"	
ANSI B17.1	2.500" 5/8" SQ		ANSI B17.1	2.625" 5/8" x 7/16"	

MAX STEM SCREW  
ACCEPTANCE DIA  
73(2.750")

INPUT FLANGE DETAILS						BASEPLATE DETAILS	
ISO F10	FLANGE	SHAFT	RECESS	RECESS	HOLE DETAILS	KEY	SPIGOT DIA.
	O/DIA. & THICKNESS	DIA.	DIA.	DEPTH	45°(OFF CENTRES)		
ISO F10	Ø125 x 10	Ø20.00-0.05	Ø70.05+0.05	5	4 HOLES Ø10.5 (Ø0.41")	6x6x40	Ø199.95-0.05
	(Ø4.92" x 0.39")	(Ø0.787"-0.002")	(Ø2.758"+0.002")	(0.20")	ON Ø102.0 (Ø4.02") P.C.	(0.24"x0.24"x1.57")	8 HOLES M16X20 (0.79") DEEP
FA10	Ø125 x 10	Ø20.00-0.05	Ø58.75+0.05	5	4 HOLES Ø10.5 (Ø0.41")	6x6x40	ON Ø254.0 (Ø10.00") P.C.
	(Ø4.92" x 0.39")	(Ø0.787"-0.002")	(Ø2.313"+0.002")	(0.20")	ON Ø102.0 (Ø4.02") P.C.	(0.24"x0.24"x1.57")	8 HOLES 5/8"UNCX20 (0.79") DEEP
							ON Ø254.4 (Ø10.00") P.C.

ISO F25	HOLE DETAILS (22.5° OFF CENTRES)	
	SPIGOT DIA.	HOLE DETAILS (22.5° OFF CENTRES)
ISO F25	Ø199.95-0.05	8 HOLES M16X20 (0.79") DEEP
	(Ø7.872"-0.002")	ON Ø254.0 (Ø10.00") P.C.
FA25	Ø152.25-0.05	8 HOLES 5/8"UNCX20 (0.79") DEEP
	(Ø5.994"-0.002")	ON Ø254.4 (Ø10.00") P.C.



IB7 GEARBOX  
F10/FA10 INPUT F25/FA25 OUTPUT

DETAILS SUBJECT TO CHANGE WITHOUT PRIOR NOTICE

FOR UP TO DATE DETAILS VISIT [www.rotork.com](http://www.rotork.com)

APPROX WEIGHT 41.1 kg

DRAWING No	PUBIB7-F10-F25	Regina House Ring Road Bramley Leeds LS134ET United Kingdom
ISSUE	A	
DATE	05/05/2011	