

- NOTE:
1. GEARBOX RATIOS : 180, 240, 360, 540, 720, 960, 1080, 1440, 2160, 2520 & 3000:1
 2. GEARBOX BASEPLATE: F35/FA35, F40/FA40, F48/FA48 & F60/FA60.
 3. DIMENSIONS WITH "*" INDICATE COVER REMOVAL ALLOWANCE
 4. THE INTERFACE PROVIDED FOR MOUNTING THE ACTUATOR OR SECOND STAGE GEARBOX ONTO THE VALVE SHOULD CONFORM TO GOOD ENGINEERING PRACTICES, ENSURING ADEQUATELY TOLERANCED LIMITS FOR PARALLELISM, PERPENDICULARITY AND CONCENTRICITY.
 5. ROTORK CANNOT BE HELD LIABLE FOR DAMAGE TO OUR EQUIPMENT CAUSED BY EXCESSIVE LOADING FROM COVER TUBES, HANDWHEEL AND HAND LEVER.

PARAMETER	VALUE	DESCRIPTION
DRAWING TYPE	A	INSTALLATION DRAWING
ACTUATOR	4	CK(R)C30/60
GEARBOX1	WA	IW10
GEARBOX2	RH	HIGH RATIO
CENTORNIK / TERMINAL	B	CTK/3 COND
MECHANISM / MOTOR	A	AID/LARGE MOT.
HANDWHEEL / REAR / FRONT	0	STD.H.W./STD.REAR/STD.FRNT.
ORIENTATION	0	STD.ORIENT.

CK range

Drawn	TAMIL	25-04-18	Title DIMENSIONAL DRAWING, CKC30/60 & CKRC30/60, IW10, HIGH RATIO, CENTRONIK / 3 CONDUIT ENTRIES, AID / LARGE MOTOR, STANDARD ORIENTATION.
Checked	BHARAT	25-04-18	
Approved	JOSE	25-04-18	

This drawing and the information it contains are property of Rotork Controls Limited, and they will not be reproduced or disclosed, in whole or in part, without the prior written consent of Rotork.

A4	Doc Number	Ver No	Scale	Sheet No
	A4WARHBA00X	1	NTS	1 of 2

CONDUIT ENTRY HOLE		
Hole	Metric	NPT
A	M32	1 1/4"
B	M25	3/4"
C	M20	3/4"

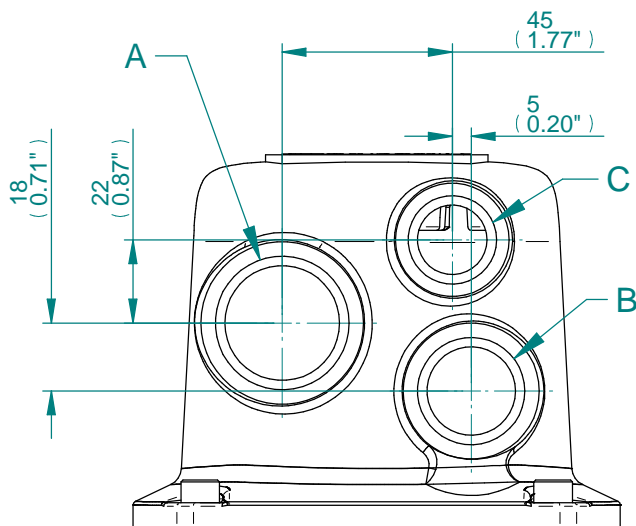

CONDUIT ENTRIES

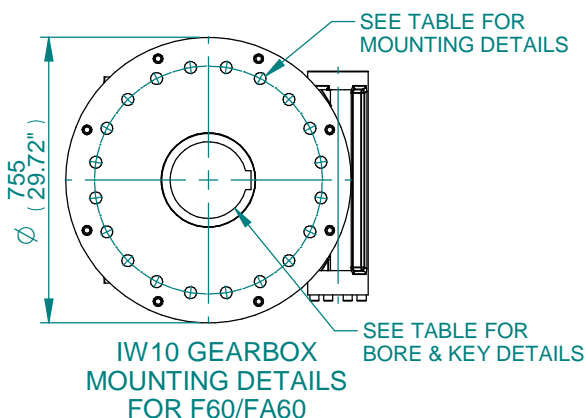
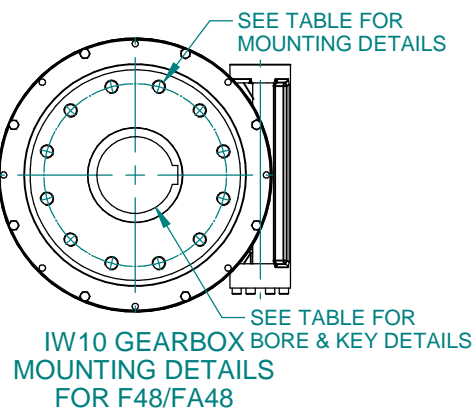
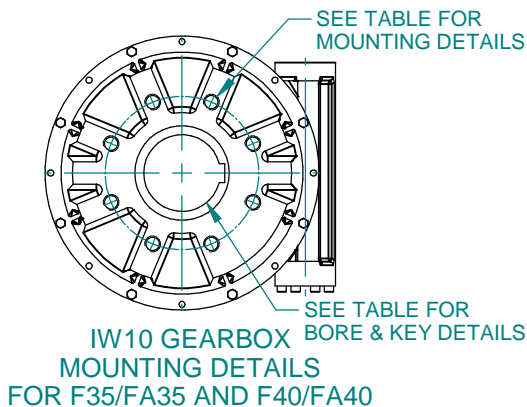

BASEPLATE	X	Y	Z
STANDARD THICKNESS	110	180	215
FILLED THICKNESS	110	180	215
WAFER THICKNESS	142	212	247

STD	MAX BORE SQ KEY		MAX BORE RECTANGULAR KEY	
	BORE	KEY	BORE	KEY
BS4235	-	-	203.0	50X28
BS46	-	-	7.625"	2"X1.3/8"
ANSI B17.1	7.375"	1.3/4"SQ	7.625"	2"X1.1/2"

BASEPLATE DETAILS		
TYPE	BASEPLATE	HOLE DETAILS (22.5° OFF CENTRES)
ISO F35	STANDARD AND FILLED	8 HOLES M30X36 (1.42") DEEP ON Ø356.0 (Ø14.02") P.C.
FA35		8 HOLES 1"UNCX36 (1.42") DEEP ON Ø355.6 (Ø14.00") P.C.
ISO F40		8 HOLES M36X36 (1.42") DEEP ON Ø406.0 (Ø15.98") P.C.
FA40		8 HOLES 1.25"UNCX36 (1.42") DEEP ON Ø406.4 (Ø16.00") P.C.
TYPE	BASEPLATE	HOLE DETAILS (15° OFF CENTRES)
ISO F48	FILLED	12 x M36 x 36 (1.42") DEEP ON Ø483.0 (Ø19.02") P.C
FA48		12 x 1.25" UNC x 36 (1.42") DEEP ON Ø482.6 (Ø19.00") P.C.
TYPE	BASEPLATE	HOLE DETAILS (9° OFF CENTRES)
ISO F60	WAFER	20 x M36 x 36 (1.42") DEEP ON Ø603.0 (Ø23.74") P.C.
FA60		20 x 1.25" UNC x 36 (1.42") DEEP ON Ø603.0 (Ø23.74") P.C.



Drawn	TAMIL	25-04-18
Checked	BHARAT	25-04-18
Approved	JOSE	25-04-18

Title DIMENSIONAL DRAWING, CKC30/60 & CKRC30/60, IW10, HIGH RATIO, CENTRONIK / 3 CONDUIT ENTRIES, AID / LARGE MOTOR, STANDARD ORIENTATION.

This drawing and the information it contains are property of Rotork Controls Limited, and they will not be reproduced or disclosed, in whole or in part, without the prior written consent of Rotork.

A4	Doc Number	Ver No	Scale	Sheet No
	A4WARHBA00X	1	NTS	2 of 2